



## CASA DIN LEMN CU TERASA COLIBRI (44 MM) 36 M<sup>2</sup> + 8M<sup>2</sup>

Prodot #AV314

**PRETUL PRODUSULUI: 10744 € (~~10744~~)**

*Pretul include: grinzi de fundatie tratate in autoclava, pereti (grinzi imbinare nut si feder pe cant si chertate la capete), podea (dusumea 20 mm imbinare nut si feder), usi si ferestre din lemn cu geam termopan (4/6/4, spatiu*



*Material Pin si Molid Nordic*  
*Grinzi de fundatie tratate in autoclava*  
*Pereti opusi interschimbabili*  
*Podea cu nut si feder inclus (in functie de modelul ales)*  
*Usi si ferestre rezistente la umiditate*  
*Feroneria inclusa*  
*Asterala cu suport intarit*  
*TVA inclus*  
*Proiect tehnic*  
*Rezistenta mai buna la putregai, mucegai si carii*  
*Fabricat protejand padurile*

# SPECIFICATIILE SI IMAGINILE TEHNICE

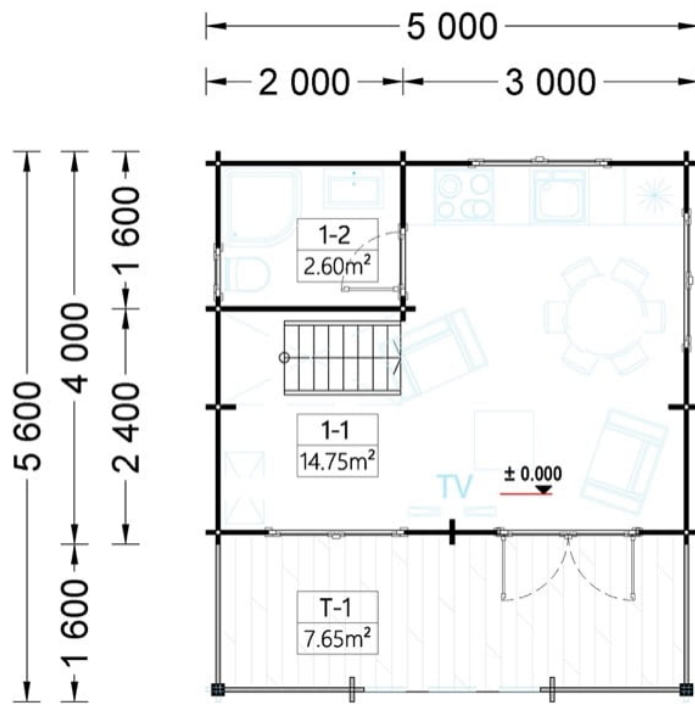

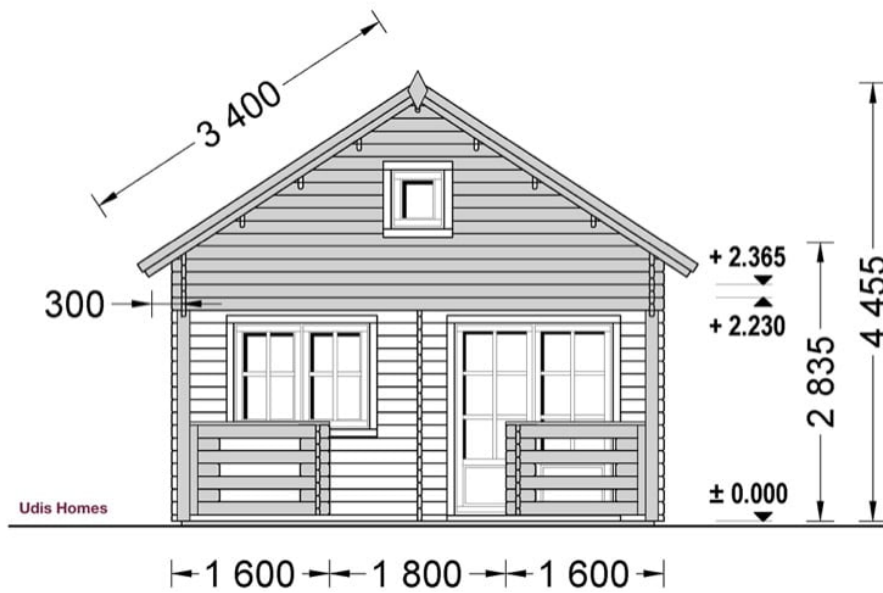
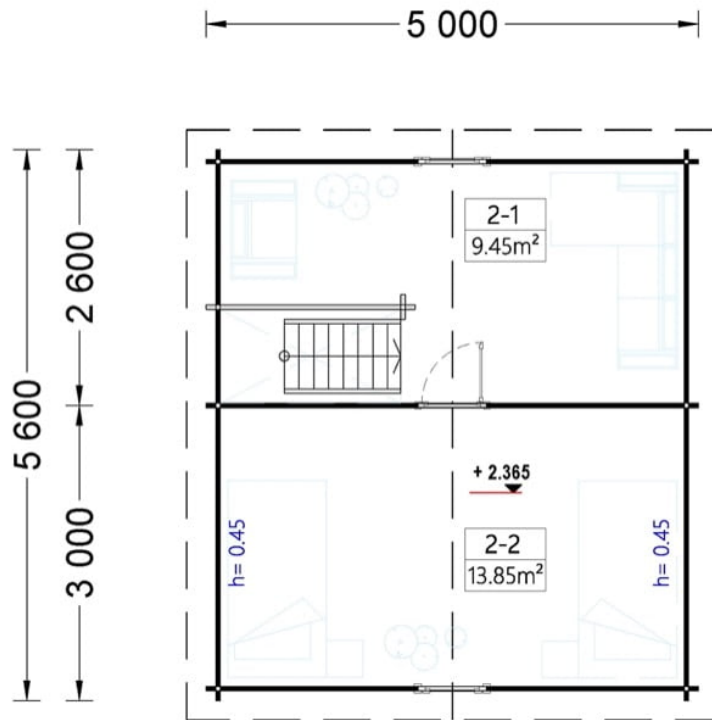

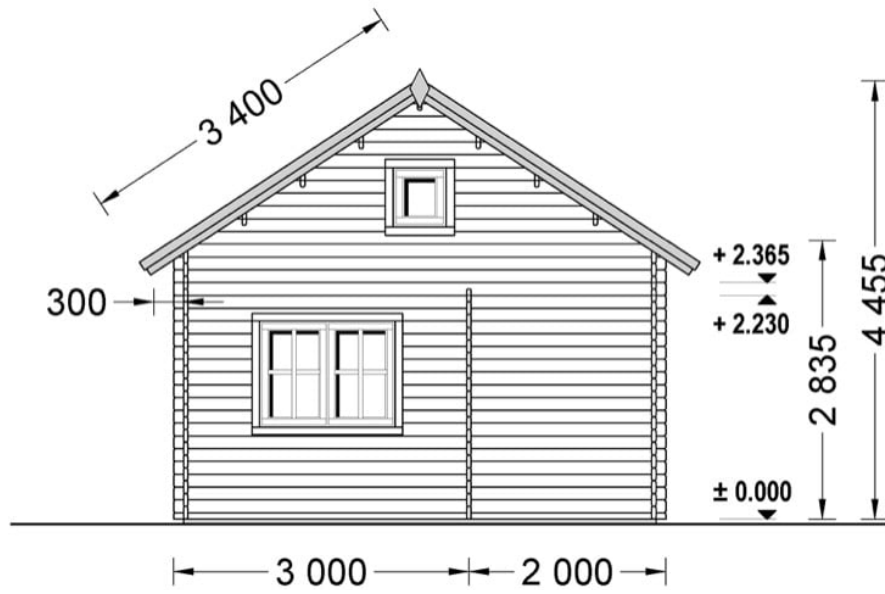
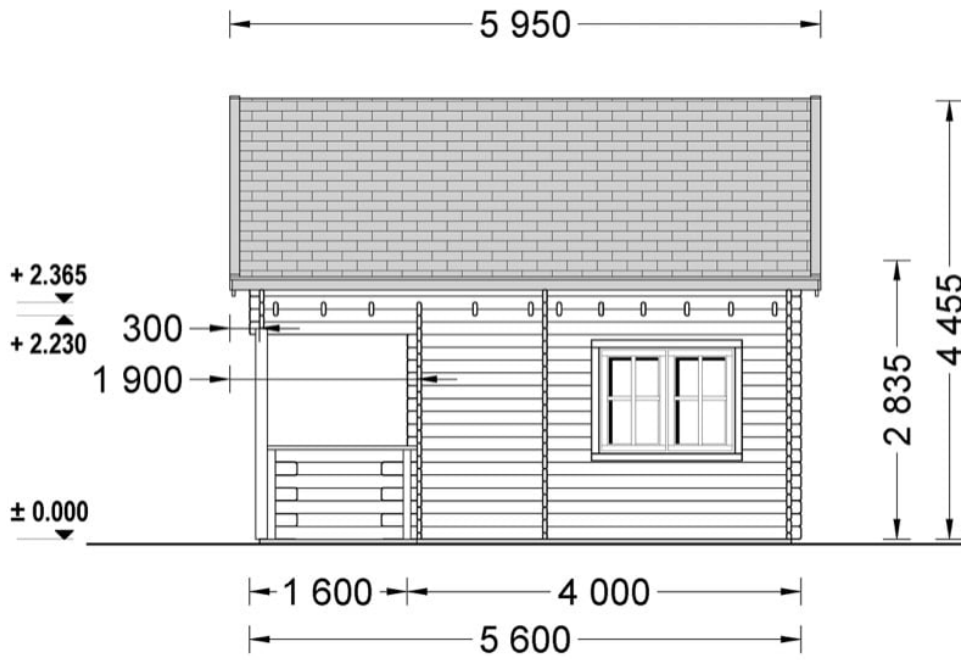

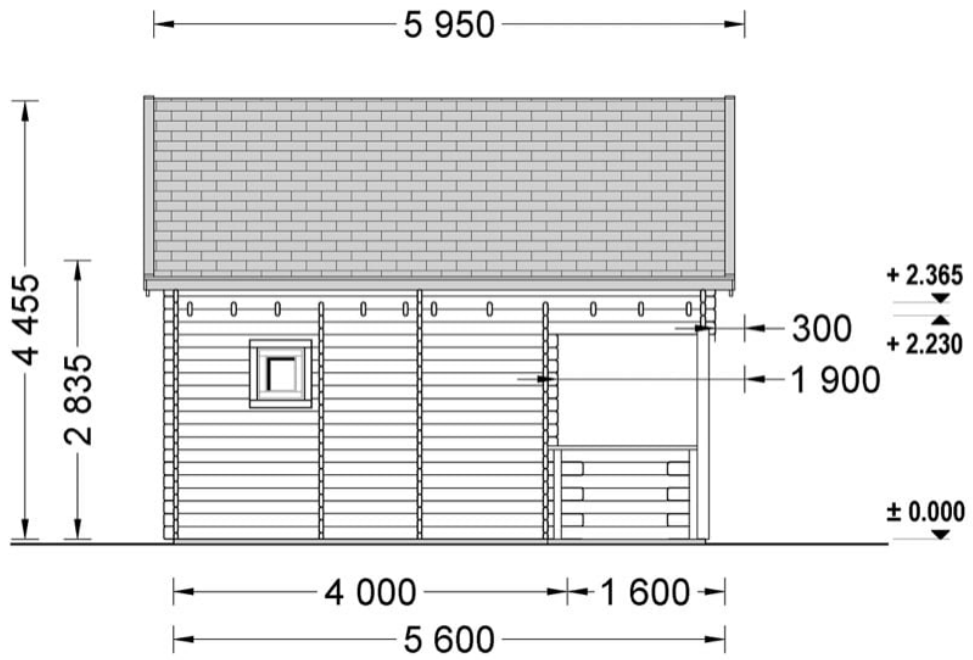



## SPECIFICATIILE TEHNICE

Dimensiuni externe	560cm x 500cm
Dimensiuni ferestre	3* 138 cm x 105 cm; 3* 50 cm x 50 cm
Grosime perete	44 mm
Inaltime la coama	445.5cm
Inaltime la streasina	283.5 cm
Material	Pin nordic natural, crescut lent
Material acoperis	Placi de grosime 19-20 mm (Nut și Feder inclus)
Material de podea	Placi de grosime 19-20 mm (Nut și Feder inclus)
Material invelitoare	Optional
Panta acoperisului	34°
Suprafata acoperis	41 mp
Tratament pentru lemn	Opțional
Usa latime x inaltime	1* 161 cm x 192 cm